

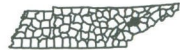

LEGEND

- 320 AVERAGE DAILY TRAFFIC VOLUME
- 40 INTERSTATE HIGHWAY SYSTEM
- 25 U.S. NUMBERED HIGHWAY SYSTEM
- 17 STATE SECONDARY HIGHWAY SYSTEM
- 20 STATE PRIMARY HIGHWAY SYSTEM
- LOCAL ROAD OR STREET
- COUNTY LINE
- STATE LINE
- INCORPORATED CITY BOUNDARY
- RESERVATION BOUNDARY
- WIDE STREAM
- 000 STATION NUMBER

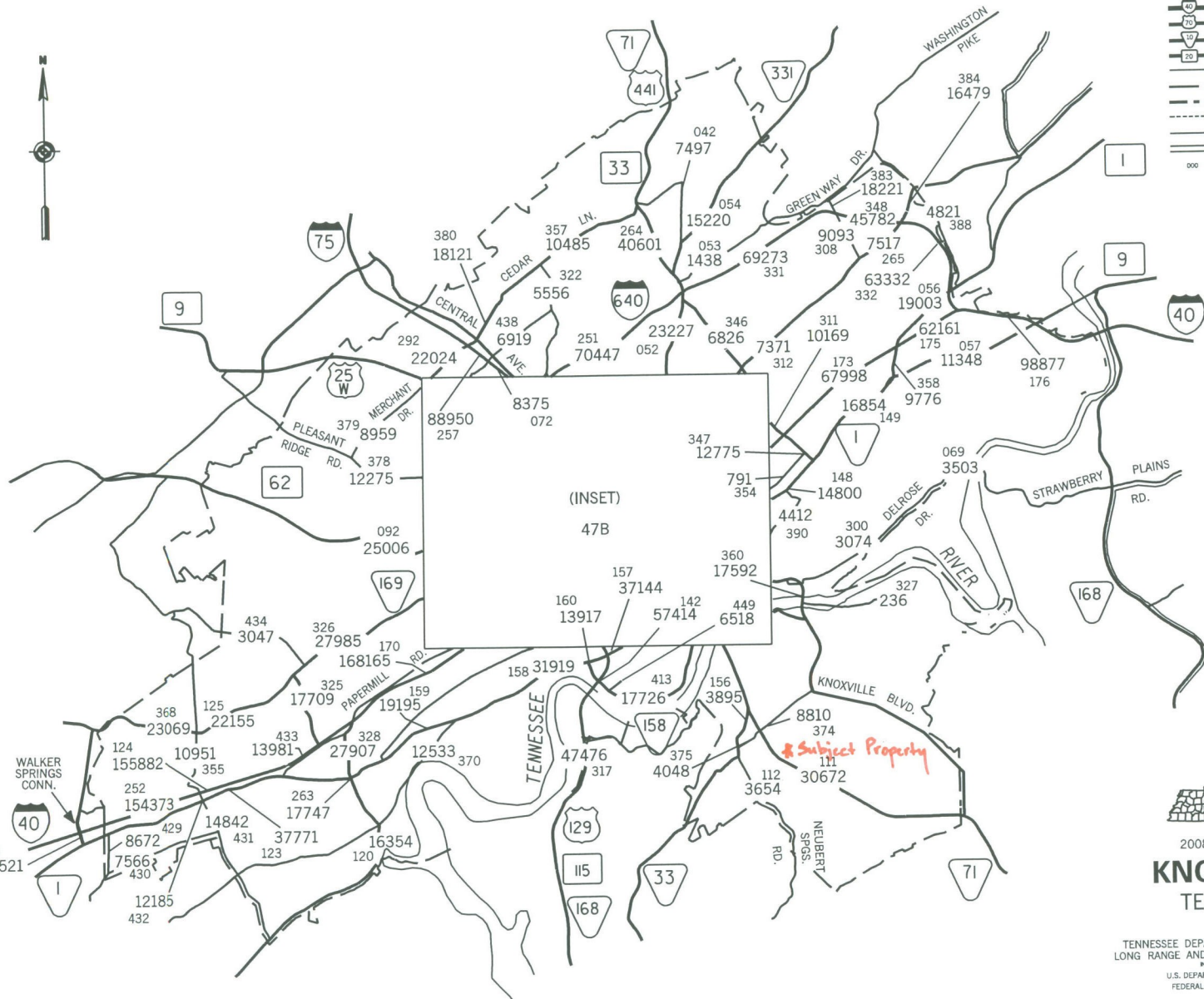

2008 TRAFFIC MAP  
**KNOXVILLE**  
TENNESSEE

PREPARED BY THE  
TENNESSEE DEPARTMENT OF TRANSPORTATION  
LONG RANGE AND PROJECT PLANNING DIVISIONS  
IN COOPERATION WITH THE  
U.S. DEPARTMENT OF TRANSPORTATION  
FEDERAL HIGHWAY ADMINISTRATION

